

## 713 Series Roloer Valve

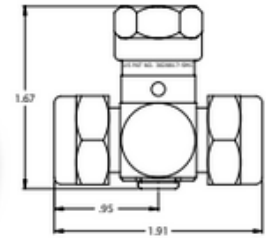

### Design Considerations

The 713 Series Roloer Valve promotes multiple configurations to fit the exact end use application. The 713 Roloer is available with a 1/4" Female NPT or 11/16-16 Swivel Nut Inlet and 11/16-16 Nozzle Thread Outlets. The 713 Roloer is commonly used as a selector valve allowing the user to switch easily between two different spray nozzles in an agricultural or industrial application. One of the Outlet Nozzle Thread Nuts is nickel plated and the other is brass for identification of the active nozzle. See our catalog information on the S/T Nozzle, Long Tee body style, for and economical alternative nozzle tip for the 713 Series Roloer Valve.

Configure your exact valve



### Specifications:

**Maximum Operating Pressure** — 500 psi

**Maximum Operating Temperature** — 180°F

#### Material Options

Brass Body, Ends, and Stem  
Teflon® Seats

#### Seal Options

Buna-N, Ethylene Propylene, Fluoroelastomer (Viton®)

#### Inlet End Options

1/4 Female NPT – Straight Stem  
11/16-16 Female Nozzle Swivel Nut

#### Outlet End Options

11/16-16 Female Nozzle Nut, Nickel Plated  
11/16-16 Female Nozzle Nut, Brass  
No Nuts (11/16-16 Male Nozzle Thread)

### Example of how to order:

Inlet End	Outlet End	Outlet End	Seal
1/4 FNPT	11/16-16 Nickel Plated Nut	11/16-16 Brass Nut	Viton

**Part Number:** 713-4F-MNZ-MNZ-F,ENP

SMC Part Numbers are a description of the Roloer Inlet and Outlet Ends, and Seal Material as read from left to right.

Example: 713-4F-MNZ-MNZ-F,ENP = 1/4 FNPT Inlet, 11/16-16 Nickel Plated Nut, Viton Seals