

Configure your exact valve

038 Series Ball Valve

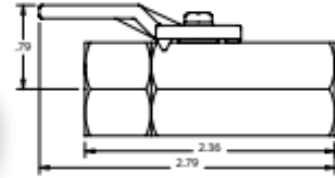

SCAN ME

Design Considerations

The 038 Series Two-Way Ball Valve compact design promotes multiple configurations to fit the exact end use application. The 038 Ball Valve Series is rated to 500 psi and will support flow and pressure in either direction. The 038 Series has a two-piece body and end construction to cover 3/8" NPT end configuration applications. The Zinc Die Cast Lever Handle is standard. Handles can be ordered Reversed - to lie over the outlet when the valve is in the open position. UL configurations are available and rated to 250 psi. UR configurations are available and rated to 500 psi.

Specifications:

Maximum Operating Pressure- 500 psi Maximum Operating Temperature- 180°F Ball Through Hole Diameter- .312

Material Options	Brass Body, Nickel Plated Brass Ball, Teflon® Seats, Stainless Handle Screw
Seal Options	Buna-N, Ethylene Propylene, Fluoroelastomer (Viton®), Neoprene
End Options	1/4, 3/8 Male and Female NPT 3/8 Compression 3/8 Hose Barb
Body Options	1/4, 3/8 Male NPT 3/8 Female NPT
Handle Options	Zinc Die Cast Lever (Standard), Zinc Die Cast Lever with Red Vinyl Sleeve, Steel Lever Handle, Steel Lever with Red Vinyl Sleeve
Plating Options	No Plating (Standard), Electroless Nickel

Example of how to order:

Inlet End	Outlet End	Seal	Handle	Plating
3/8 Compression	3/8 MNPT	Buna-N	Steel	ENP

Part Number: 038-6C6M-B,SH,ENP

The handle will lie over the Inlet port when the valve is in the open position. Part Numbers are a description of the valve as read left to right, Inlet to Outlet.

Example: 038-6C6M-B,SH,ENP = 3/8 Compression Inlet x 3/8 MNPT Outlet